



SOLFRESH

Antimicrobial flooring for:

- Food and Beverage
- Meat and Fish
- Bakeries
- Food Preparation
- Healthcare
- Pharmaceutical



Polygiene®

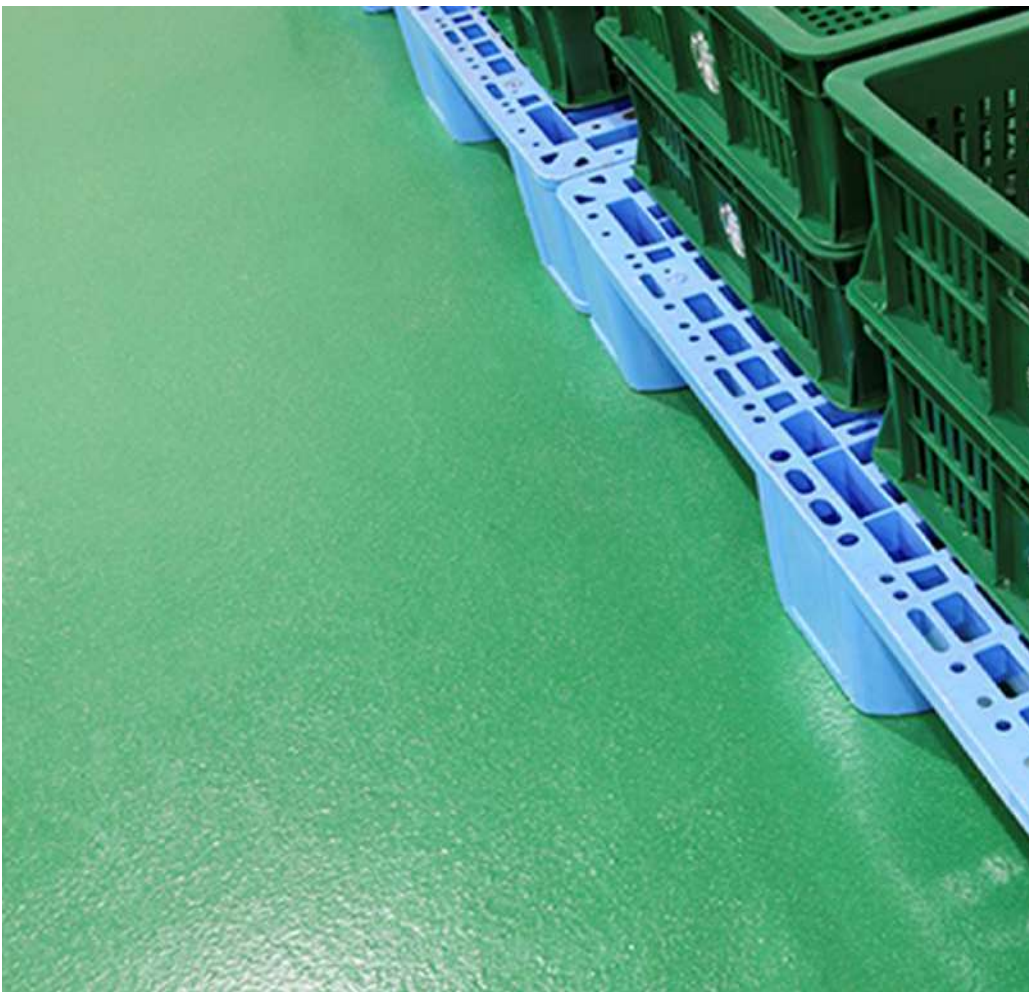

Technical Profile

Solfresh represents a new generation of performance antimicrobial flooring based on the use of Silver, in partnership with Polygiene, that kills up to 99.9% of bacteria on contact.

Silver is a natural element known for its ability to purify and protect from bacterial infections- and provides an attractive, environmentally friendly alternative to chemically manufactured anti-microbials.

Offering total protection, a continuous migration of silver ions are delivered to the contact surface from where they attack gram positive and gram negative bacteria and viruses. This technology remains active for the lifetime of the floor, even when damaged or worn unlike coatings or surface treatments.

Application Suitability



Food & Beverage



Meat & fish



Bakeries & Confectionery



Food preparation & Kitchens



Hospitals & Healthcare



Pharmaceutical

Resistance Chart

BACTERIAL RESISTANCE				CHEMICAL RESISTANCE			
SARS-CoV	YES	Salmonella Typhi	YES	Hydrochloric acid	YES	Methanol	YES
MRSA	YES	Enterococcus Faecalis	YES	Sulphuric acid	YES	Sugar Syrups	YES
E-Coli	YES	Staphylococcus Aureus	YES	Citric acid	YES	Caustic Soda	YES
Listeria	YES	Streptococcus Pyogenes	YES	Acetic acid	YES	Petrol	YES
C.difficile	YES	Pseudomonas Aeruginosa	YES	Lactic acid	YES	Oil Ingredients	YES
Proteus Vulgaris	YES	Campylobacter	YES	Phosphoric acid	YES	Detergents	YES

Complimentary Products

	Description	Uses
Floorprime	A 2-component low viscosity epoxy resin primer for cementitious substrates.	Applied to screeds prior to overcoating with resin floor finishes.
Solfresh primer	A 3-component, polyurethane scratch coat/ primer for concrete and cementitious substrates. Solfresh primer will bond to surface dry substrates that have a Relative humidity up to 97% (to BS 8204)	For priming concrete and screeds, prior to overcoating with the Solfresh flooring system.
Solfresh coating	A 4-component water based polyurethane coating.	Used as a sealer coat from Solfresh WR or as an alternative sealer for Solfresh HF.
Super Satin	A 2-component waterborne polyurethane formulated to provide an ultra-durable clear coating with matt finish.	Used as a sealer coat where a matt finish is essential.
Floorseal Ultra	A 2-component fast curing polyurea sealer with good UV stability.	Used as fast curing UV stable sealer for flake & quartz broadcast systems. Or as a concrete coating with high abrasion & wear resistance.
Solflex	A 2-component polyurethane joint sealant.	To strengthen and protect limited movement floor joints.

Joint Details

Typical (induced) Movement Joint

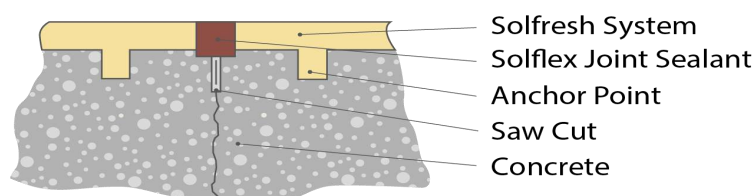

Typical (expansion) Movement Joint

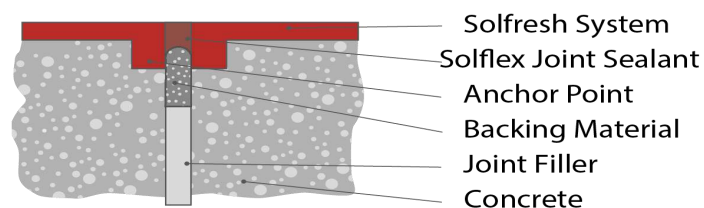

Typical Drainage Chanel Arrangement

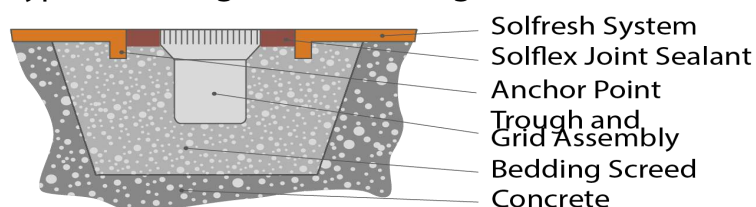

Typical Floor to Wall Detail

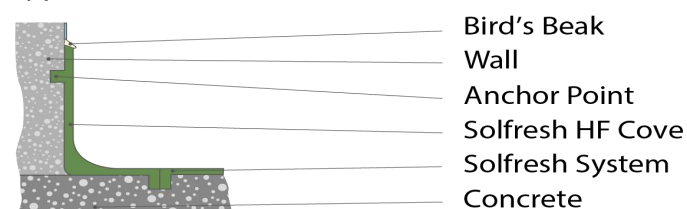

Solcrete Solfresh SL & MF (2-4mm)

Smooth, matt polyurethane screeds for use in wet and dry areas subject to light-medium traffic.

Best suited to packaging areas and processing zones subject to light-medium foot and wheeled traffic, these rake applied systems deliver a seamless joint-free finish.

Chemical resistant:

Protects against the majority of acids used in manufacturing processes.

Abrasion resistant:

Holds its own against impact, traffic and chemical attack.

Hygienic:

Contains Polygiene- an antimicrobial additive that kills up to 99.9% bacteria.

Easy to clean:

Minimal joints makes this flooring easy to sterilize.

Low Odor:

Improved air quality during installation and beyond.

Technical Profile

THICKNESS	2MM (SL) 3-4MM (MF)
FIRE RESISTANCE	BS476-7 CLASS 2
TEMPERATURE RESISTANCE	5C- 65C (SL), -5C-70C (MF @ 3MM), -15C-90C (MF @ 4MM)
WATER PERMEABILITY (KERSTEN TEST)	NIL (IMPERMEABLE)
SLIP RESISTANCE (TRRL Pendulum Slip Test)	Dry >70 Wet >25
COMPRESSIVE STRENGTH	BS6319 >50N/mm ²
FLEXURAL STRENGTH	BS6319 >20N/mm ²
TENSILE STRENGTH	BS6319 >12N/mm ²
BOND STRENGTH	>1.5MPa*
COEFFICIENT OF THERMAL EXPANSION	ASTM C531 5.70*10 ⁻⁵ C(1-)

Color Chart

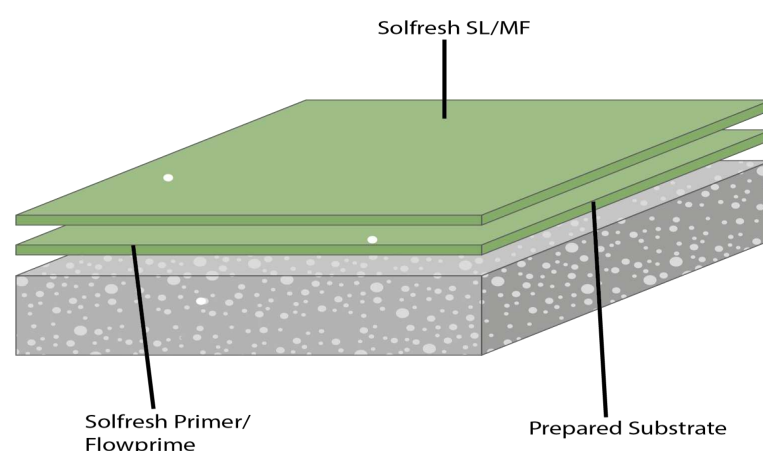

Application Suitability

Light-medium traffic 2mm

Medium-heavy traffic 3-4mm

Industrial kitchens/Semi Dry Areas

Packaging areas

Loading bays

Laboratories/Quality Control



Solcrete Solfresh MF & RT (6-9mm)

Slip-resistant polyurethane screeds for use in wet areas subject to high volumes of traffic

Best suited to wet processing zones subject to high volumes of foot and wheeled traffic, these trowel applied 6-9mm systems deliver a seamless joint-free matt finish.

Heat Resistant:

Resistant to high extreme thermal variations of between -40°C and 140°C

Slip resistant:

Impressive anti-slip profile in both dry and wet conditions.

Hygienic:

Contains Polygiene- an antimicrobial additive that kills up to 99.9% bacteria.

Chemical Resistant:

Protects against the majority of acids used in manufacturing processes.

Durable

Holds its own against impact as well as heavy traffic.

Color Chart



Technical Profile

THICKNESS	6-9MM
FIRE RESISTANCE	BS476-7, CLASS 2
TEMPERATURE RESISTANCE	-25C-100C @ 6MM, -45C-120C (9MM)
WATER PERMEABILITY (Karsten Test)	NIL (IMPERMEABLE)
SLIP RESISTANCE (TRRL Pendulum Slip Test)	Dry >80 Wet >35
COMPRESSIVE STRENGTH	BS6319, >60N/mm ²
FLEXURAL STRENGTH	BS6319, >20N/mm ²
TENSILE STRENGTH	BS6319, >10N/mm ²
BOND STRENGTH	>MPa*
COEFFICIENT OF THERMAL EXPANSION	3.74*10(-5)C (-1)

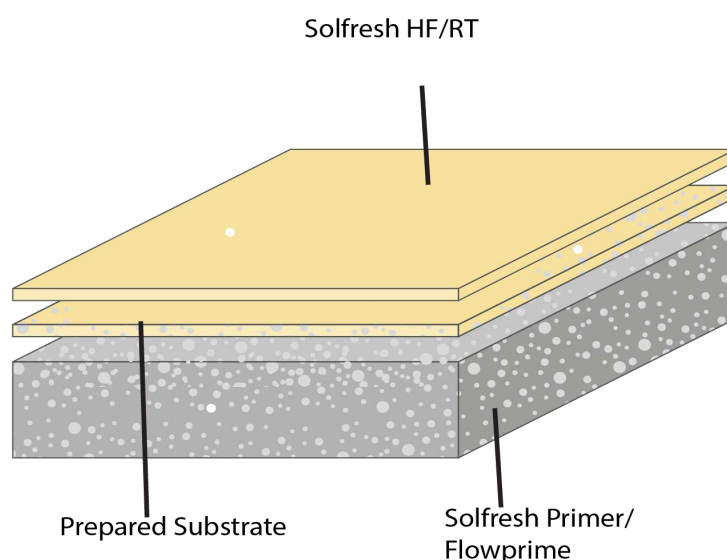



Nairobi Industrial Area,
Road A, Off Enterprise Road,
Within Alpine Coolers Godowns

P.O. Box 6351— 00300, Nairobi, Kenya.

info@solcretecontractors.com

www.solcretecontractors.com

+254 707 961 472 | +254 735 988 525